

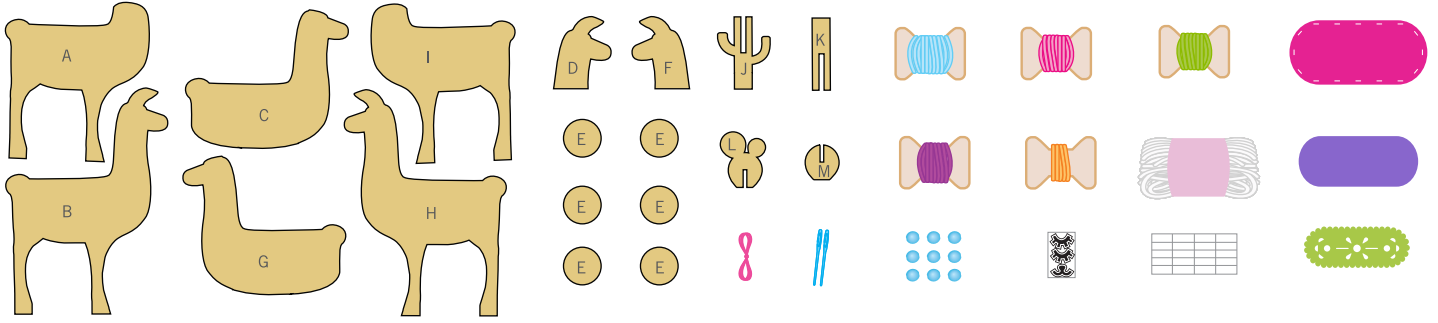

PLEASE SCAN THE QR CODE FOR VIEWING MULTI-LANGUAGE INSTRUCTIONS.
FR. Veuillez scanner le code QR pour afficher les instructions multilingues pour ce kit. DE. Bitte scanne den QR-Code, um die mehrsprachige Anleitung für dieses Set anzusehen. NL. Scan de QR-code om de instructies voor deze set in verschillende talen te bekijken. IT. Scansiona il codice QR per visualizzare le istruzioni multi-lingua per questo kit. ES. Escane el código QR para ver instrucciones en varios idiomas para este kit. JA. QRコードをスキャンして、本キットの多言語説明書をご覧ください。

WARNING:
CHOKING HAZARD - Small parts.
Not for Children under 3 years.
Plastic Needles Contain Functional Sharp Point.

A. CONTENTS



18 pre-cut cardboard shapes, 3 pre-cut felt shapes, 1 spool of embroidery thread, 9 beads, 6 spools of yarn, 1 pair of plastic needles, eye and nose stickers, double-sided adhesive tape and detailed instructions.

B. ASSEMBLING THE CARDBOARD

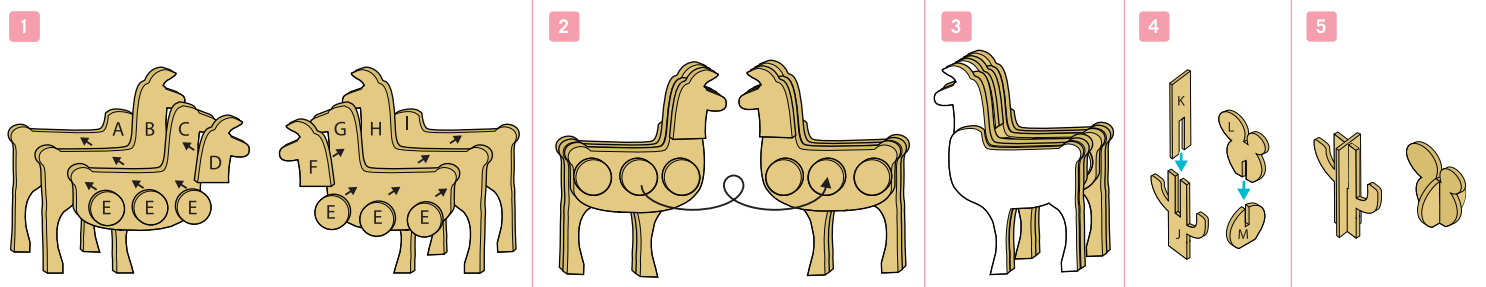

1. Stack up the cardboard shapes as illustrated using the double-sided tape provided to form the llama's two halves. The brown side of the cardboard shapes should be facing you when you put the pieces together.
2. Combine and stick the two halves to form a complete llama.
3. Once assembled, the cardboard llama should look like this.
4. Slot the cactus shapes as illustrated (K→J & L→M).
5. Once put together, the cactus cardboard shapes should look like this.

C. HOW TO WRAP LLAMA DOLL WITH YARN

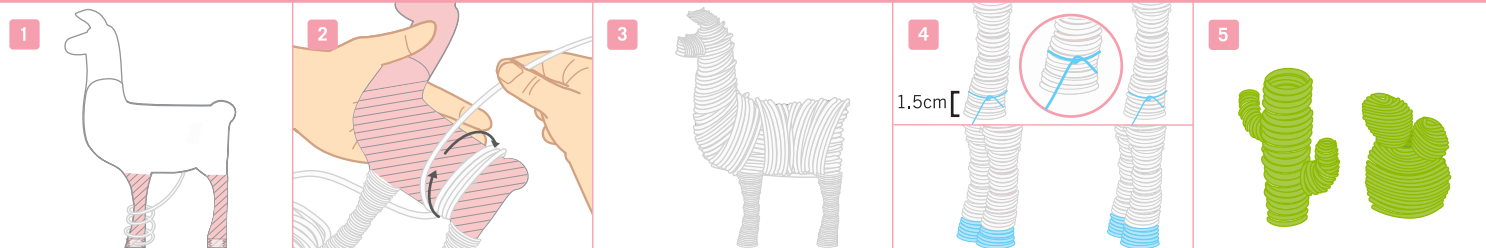

1. Cut four 160-cm long strings of white yarn from the spool. Stick one piece of double-sided adhesive tape on the bottom of each leg. Then, wind the white yarn tightly from the bottom to the top of each leg. Cut the excess string when you reach the top of the leg and hide the string's end inside the wrapped yarn. Continue on to cover all the legs in yarn.
2. Use the same technique to wind the yarn over the whole body. Use a piece of double-sided adhesive tape to hold the yarn's tip in place.
3. The cardboard should now be fully covered in yarn.
4. Take a 30-cm long blue yarn and tie a knot 1.5cm above from the bottom of the leg, then wind downwards to make a blue horseshoe on each leg.
5. Wrap each cactus shape with 600cm of green yarn using the same method.

D. MAKING A DECORATIVE BRAID

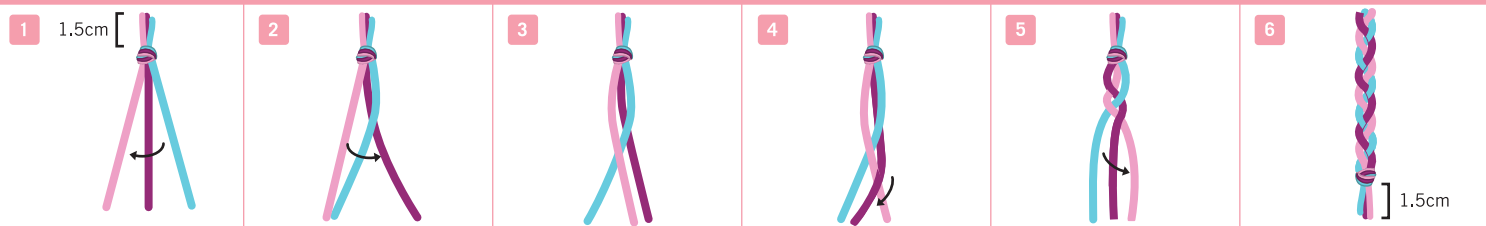

1. Tie a knot with the pink, purple and blue yarn. Remember to leave 1.5cm of extra yarn behind the knot you tie. Afterwards, place the blue yarn over the purple yarn as shown.
2. Place the pink yarn over the blue yarn. The pink yarn should now be on top of the blue and purple yarn ends.
3. Correct color order starting with the yarn closest to you: 1. Pink 2. Blue 3. Purple
4. Bring the purple yarn over to the middle, placing it on top of the pink yarn.
5. Place the blue yarn on top of the purple yarn.
6. Repeat steps 2-5 to continue braiding. Tie the final knot when there is around 1.5cm of yarn left.

E. DECORATING YOUR LLAMA

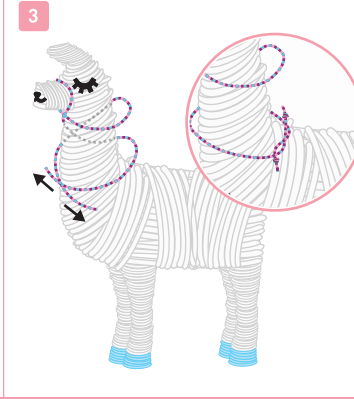
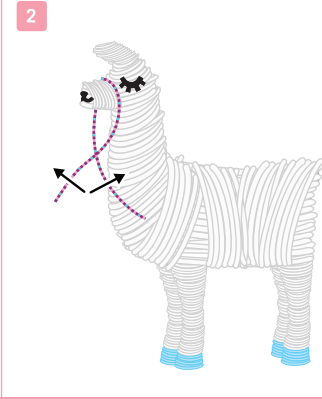
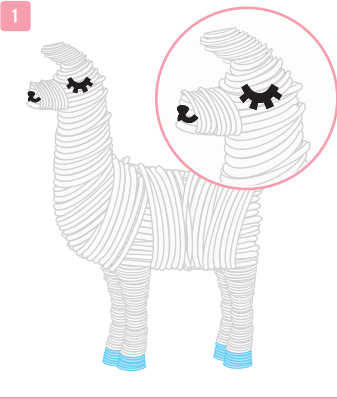

1. Stick the eye and mouth stickers onto the llama's head.
2. Wind the braided yarn you made in Section D around the nose.
3. Then, wind around the llama's neck twice and tie a knot to secure it.

F. MAKING THE HEAD ACCESSORIES

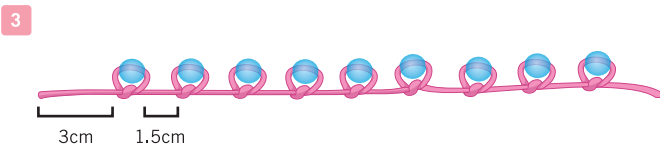
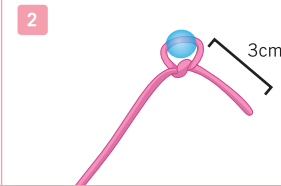
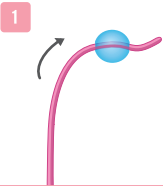

1. Thread the pink cord through a blue bead.
2. Tie a knot to secure the bead, leaving 3cm of extra pink cord at the end.
3. Thread and secure another bead using the same technique while keeping 1.5cm of space in between each bead. Repeat the steps with the remaining beads.
4. Once complete, wrap the bead string around the top of the llama's head and secure it with a knot.

G. HOW TO THREAD YARN THROUGH A NEEDLE

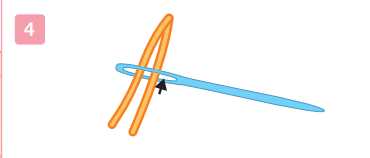
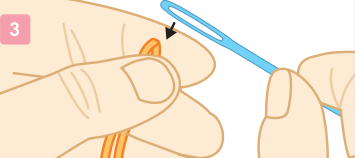
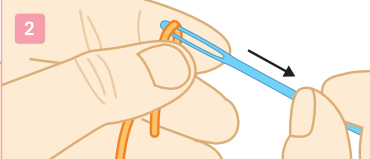
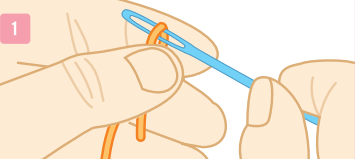

1. Fold the yarn tightly around the eye of the needle. Once in place, pinch the yarn firmly around the needle with your left thumb and forefinger.
2. Pull the needle out of the yarn. Keep holding the yarn tightly with your left thumb and forefinger. You should now have a crisply folded piece of yarn in one hand.
3. Push the folded end through the eye of the needle.
4. Your needle should now be threaded with a yarn loop.

H. DECORATING THE FELT

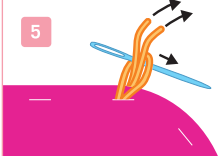
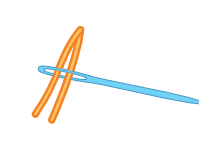
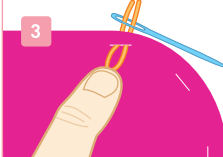
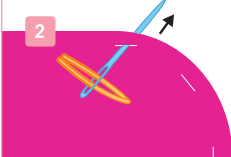
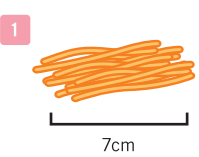

1. Cut 16 pieces of 7cm-long orange yarn. Thread one piece of yarn through the needle using the technique in Section G.
2. Pass the needle through one of the holes on the pink felt.
3. Hold onto the small loop so it does not accidentally slip out while you are threading the needle through the hole.
4. Thread the yarn with the needle's back-end through the yarn loop you created earlier.
5. Carefully remove the needle and pull the yarn ends to secure the loop. Repeat the steps to decorate all of the felt's holes.

I. DRESSING YOUR LLAMA DOLL

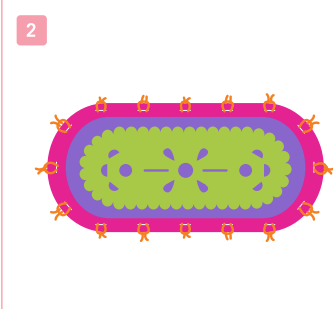
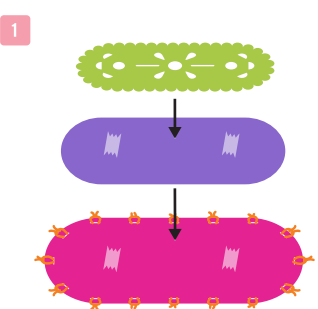

1. Stick the felt shapes together using the double-sided adhesive tape.
2. The end result of the previous step should look like this.
3. Stick it onto your llama's back. Gorgeous! Your llama doll is now finished!